

amphion[®] enjoy

Helium

Reference manual
1/2022

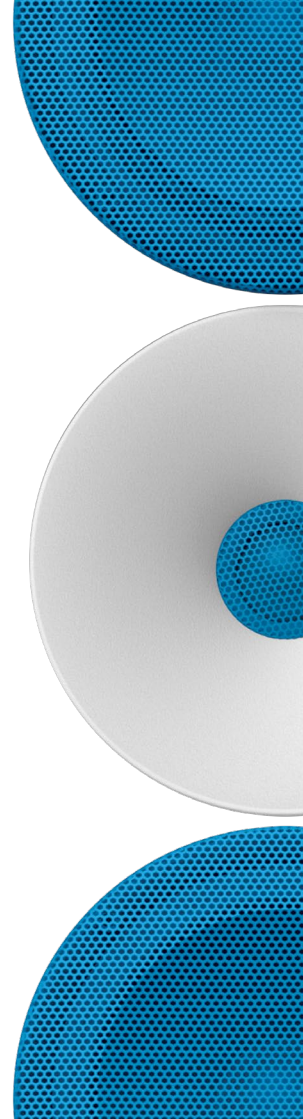

Contents

Introduction	2
Warranty and support	3
Company profile	4
Helium line	5
Speaker placement	7
Wall and ceiling brackets	8
Technologies	9
Instructions	11
Loudspeaker grids	14
Technical specifications	15

Introduction

Welcome

Thank you for choosing Amphion.

Your new speaker is based on the same advanced acoustical engineering, which world's top sound engineers trust and enjoy daily. We have made our products as room friendly and natural as possible, so that you can be touched by the beauty of sound regardless of what you listen to. Kindly do not hesitate to get in touch with us or your dealer in order to get most of investment. Timeless design, best possible materials and the skilled hands of experienced Finnish craftsmen are used in order to ensure years of daily pleasure.

Joy is best when shared. Please let us know via email or social media how you or those close to you enjoy your Amphions.

Now unpack, connect, sit back, and experience them. Enjoy!



Anssi Hyvönen
Founder & Managing Director, Amphion Loudspeakers Ltd.

Warranty and support

Warranty

Amphion Enjoy products come with a five-year warranty against defects in materials and our workmanship. For warranty or out-of-warranty service, in the first instance please contact your original dealer, and provide a copy of the original sales receipt. If you require additional assistance, please contact your local country distributor. If you have difficulty making contact with either of the above, please contact our headquarters. For proper unpacking, installation, positioning, and maintenance instructions, please first check this manual thoroughly.



Please do not return/ship any product to amphion nor its resellers without prior authorisation.

Handmade in Finland

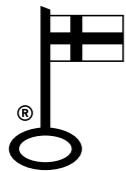

Amphion Loudspeakers Ltd. is awarded the right to use the Association for Finnish Work's Key Flag Symbol mark of origin. This mark is granted to Finland-based organizations that manufacture their products in Finland, having a minimum domestic content of 50 percent.

Company profile

About us

Amphion Loudspeakers Ltd. was established in 1998.

We design and build loudspeakers that are characterised by high-resolution, unstrained low-level reproduction and pure driver integration. Our affordable solutions are rather insensitive to room acoustics and fill any space with a wide and even dispersion. A timeless yet flexible approach with regard to aesthetics and application make Amphion products easy to match with individual styles and preferences.

All products are handmade in Finland to ensure enduring listening quality.

Follow us

amphion.fi

Social media

-  www.facebook.com/AmphionLoudspeakers
-  twitter.com/amphion_fi
-  www.youtube.com/user/AmphionLoudspeakers
-  www.instagram.com/amphion_loudspeakers

Amphion Sounds, corporate newsletter

www.amphion.fi/en/enjoy/signup

Helium line

Story

Superb sound in any space

Helium is your first step on the road to a truly rewarding audio experience. Whether you're listening to music, using streaming services, or watching a movie with family or friends, the clear, natural sound quality brings it all to life. Regardless of where a Helium speaker is placed in the room, its controlled dispersion delivers pleasing, neutral audio – even at low volumes.



Helium410



Helium510



Helium520C



Helium520

Helium speakers are available in Full White, Standard White, Black and Walnut veneer. Grids available in the RAL-colours of your choice.

Monochrome

- Full white
- White with black grids
- Standard white
- Black

Wood veneers

- Walnut

Colour grid options

- Stone grey
- Beige brown
- Turquoise blue
- Sky blue
- Heather violet
- Traffic red
- Sulfur yellow
- Yellow green
- RAL colour of choice (POA)

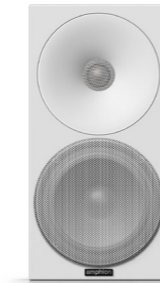

Speaker placement

Acoustic centre-point of the speakers

This is either between the end of the waveguide and driver (single-woofer product) or tweeter centre (two-woofer product).

Phantom Centre

For correct stereo imaging do not place speakers too far apart. Use a vocal track where the singer is in the centre. Move speakers wider apart to hear the “hole” developing in the middle of the soundstage, then move them closer until channels integrate.

3D | Depth Information

Start by aiming a direct line from the acoustic centre-point to outside your shoulder line. Then “fine-tune” the sound to your liking. Note that highest treble is always directive. Adding higher treble may actually smoothen the audio in the upper-midrange.

Tilting - If Needed

Small wedges at either front or back edges of speaker help to align/aim the acoustic centre to the listeners ear. It is not overly critical but helps achieve the required sound.

Wall/Ceiling brackets

for
Amphion
Loudspeakers
Ceiling and Wall
applications

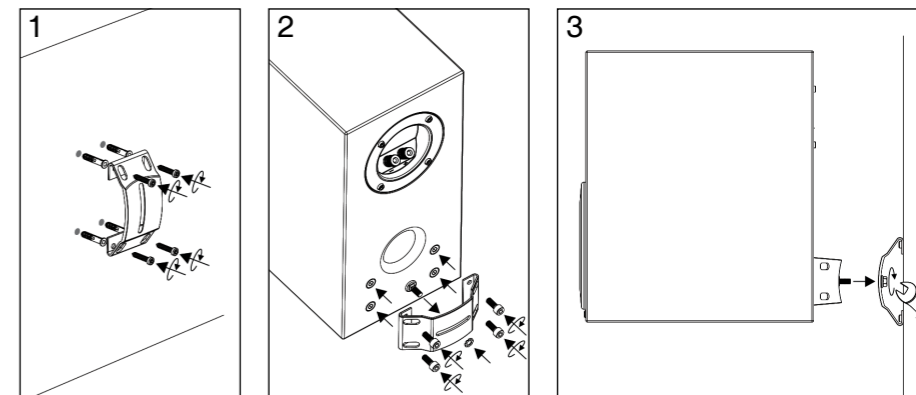

Technologies



What is a Waveguide?

Waveguide: A generic term to describe a structure that directs sound waves, with minimal loss of energy, by restricting their expansion to one or two dimensions. It helps create a wide, even sweet spot - though highest treble is always directive. It solves cabinet diffraction issues, aligns drivers, and makes dispersion-patterns between drivers more even across a wide frequency-band.

Amphion's proprietary waveguide: Amphion is a frontrunner in waveguide technology, and is widely recognised for their use of tweeter waveguides in front of the driver to control directionality - incorporating a technology called U/D/D (Uniformly Directive Diffusion).

Perfecting driver integration: The result is purer, more natural sound that is less interrupted by room acoustics, and helps speakers deliver clarity and naturalness - even when placed close to boundaries eg. walls, bookshelves, desktops, or highly-reflective surfaces. It creates a large, broad sweet spot suitable for busy modern living, where one cannot always sit in the sweet spot.

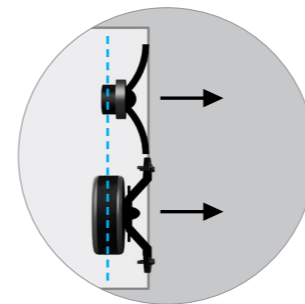

Time-adjusted drivers

All products use time-adjusted drivers and a 1600 Hz tweeter crossover. This leads into point-source-like behavior and seamless driver integration. Rock-solid "phantom" centre, life-like 3D imaging, and an extremely wide and deep sweet-spot are characteristic of all Amphion products.

Instructions

Helium410 / Helium510 / Helium 520C

Unpacking

1

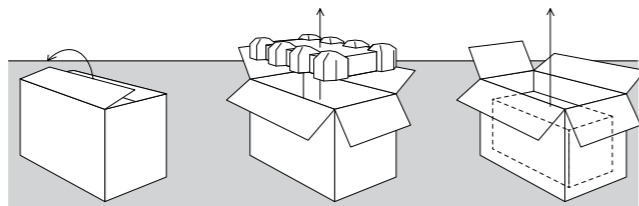

2

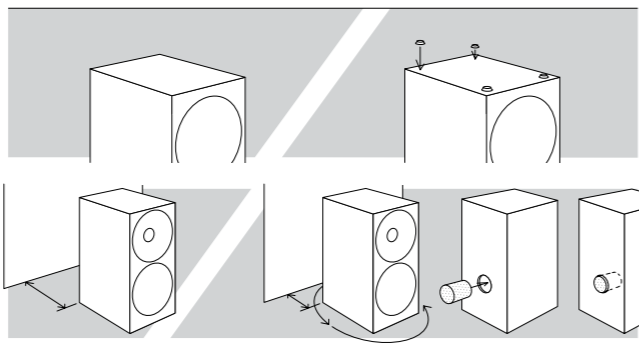

Connecting

3

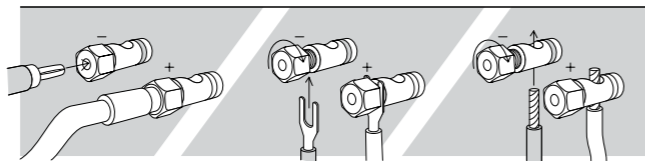

Helium520

Unpacking

1

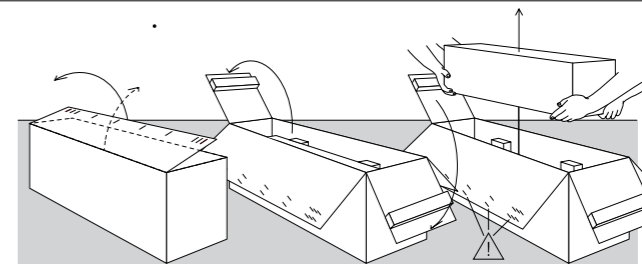

2

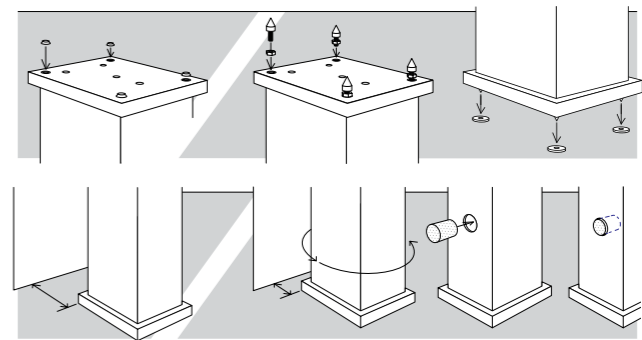

Connecting

3

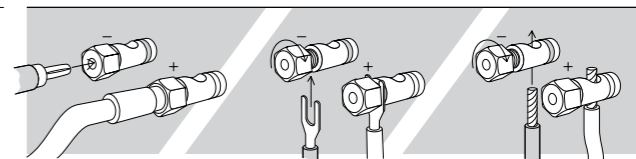

Care

Cleaning



- When setting or re-positioning speakers, wear soft cotton gloves.
- To clean, use a soft cotton or microfiber cloth. Do not use excess rubbing-force.
- Use water or CIF Multi-surface Window Cleaner (e.g. JIF, HANDY ANDY, VIM, VISS).
- Spray cleaner onto the cloth first, rather than directly onto the cabinet.
- Test-clean a small area on the back or under the cabinet to check surface reaction.
- When cleaning the walnut-finish, wipe in the direction of the wood-grain.

Individual support

Typically, a wide variety of factors influence loudspeakers' performance. Please contact your local Amphon dealer or sales representative for specification, connectivity and positioning recommendations for your specific system. For more information, you can also be in touch with Amphon headquarters.

Loudspeaker grids

Colour grid options

- Stone grey
- Beige brown
- Turquoise blue
- Sky blue
- Heather violet
- Traffic red
- Sulfur yellow
- Yellow green
- RAL colour of choice (POA)

Amphon loudspeakers come with grids of your colour of choice. Do you want to change the looks later on?

Just pick another colour and replace the grids.

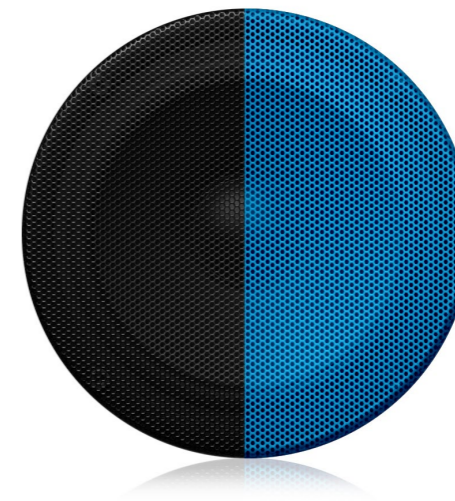

Technical specifications

Helium410



Physics

Operating principle	Two-way, vented
Tweeter	1" titanium tweeter
Mid / woofer	4 1/2" paper woofer
Measurements	259 x 132 x 220 mm
Weight	4 kg (9 lbs)

Performance

Crossover point	1600 Hz
Impedance	8 Ω
Sensitivity	86 dB
Frequency response	52 – 25.000 Hz -6dB
Power recommendation	20 – 80 W

Variations

Monochrome	
Wood veneer	
Colour grids	

Helium510



Physics

Operating principle	Two-way, vented
Tweeter	1" titanium tweeter
Mid / woofer	5 1/4" paper woofer
Measurements	316 x 160 x 265 mm
Weight	6 kg (13 lbs)

Performance

Crossover point	1600 Hz
Impedance	8 Ω
Sensitivity	86 dB
Frequency response	48 – 25.000 Hz -6dB
Power recommendation	20 – 100 W

Variations

Monochrome	
Wood veneer	
Colour grids	

Technical specifications

Helium520C

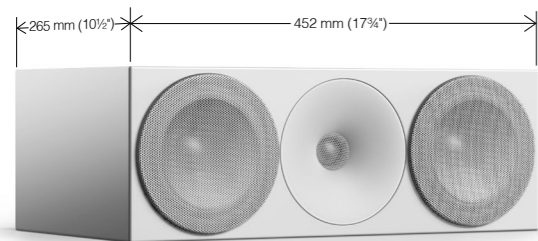

Physics

Operating principle	Two-way, vented
Tweeter	1" titanium tweeter
Mid / woofer	2 x 5 1/4" paper woofer
Measurements	452 x 160 x 265 mm
Weight	9 kg (20 lbs)

Performance

Crossover point	1600 Hz
Impedance	4 Ω
Sensitivity	90 dB
Frequency response	48 – 25.000 Hz -6dB
Power recommendation	10 – 150 W

Variations

Monochrome	
Wood veneer	
Colour grids	

Helium520



Physics

Operating principle	Two-way, vented
Tweeter	1" titanium tweeter
Mid / woofer	2 x 5 1/4" paper woofer
Measurements	1072 x 218 x 270 mm
Weight	17 kg (38 lbs)

Performance

Crossover point	1600 Hz
Impedance	4 Ω
Sensitivity	90 dB
Frequency response	40 – 25.000 Hz -6dB
Power recommendation	10 – 150 W

Variations

Monochrome	
Wood veneer	
Colour grids	

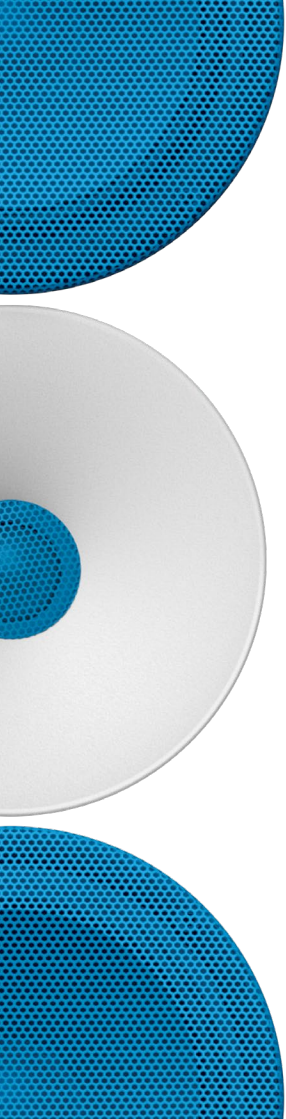

Amphion Loudspeakers Ltd.

Telkkistentie 2
70460 Kuopio
Finland

+358 17 2882100
info@amphion.fi
amphion.fi